

FOR LEASE 3562 Round Barn Circle | Santa Rosa

# Fountaingrove Executive Center



Santa Rosa's Most Prestigious Submarket



FOR LEASE **Santa Rosa**  
**Fountaingrove Executive Center**



**TWO SUITES AVAILABLE  
OFFICE SPACE  
AVAILABLE**

Type:  
**Class A Office**

Address:  
**3562 Round Barn Circle  
Santa Rosa, CA**

Range of Available SF:  
**Third Floor: 5,249 & 7,844  
Combined: 13,093**

# of Floors: Three (3)

**DESCRIPTION**

Suites 300 & 330 offer the perfect mix of private office and open space with an extensive glass line. The space is accessed directly off of the elevator for great tenant identity.

**LOCATION**

3562 Round Barn Circle is just ten minutes from Sonoma County Airport. The center's close proximity to Highway 101 means tenants can enjoy the nearby Coddington Mall, Fountainrove Golf and Athletic Club, Wells Fargo Center for the Arts as well as a wide selection of retail, restaurants and other services.

**AMENITIES**

- Expansive floor to ceiling glass line
- High-speed technology access
- 10' finished ceiling height
- Restrooms with showers and lockers
- Space planning flexibility
- High quality building standard finishes

**KEY TENANTS**

Morgan Stanley  
Pisenti & Brinker  
NBC Services



EXCLUSIVELY MARKETED BY:  
**Shawn Johnson**  
DRE#: 00835502

# FOR LEASE Santa Rosa Fountaingrove Executive Center



EXCLUSIVELY MARKETED BY:  
**Shawn Johnson**  
DRE#: 00835502

FOR LEASE **Santa Rosa**  
**Fountaingrove Executive Center**



EXCLUSIVELY MARKETED BY:  
**Shawn Johnson**  
DRE#: 00835502

FOR LEASE **Santa Rosa**

# Fountaingrove Executive Center

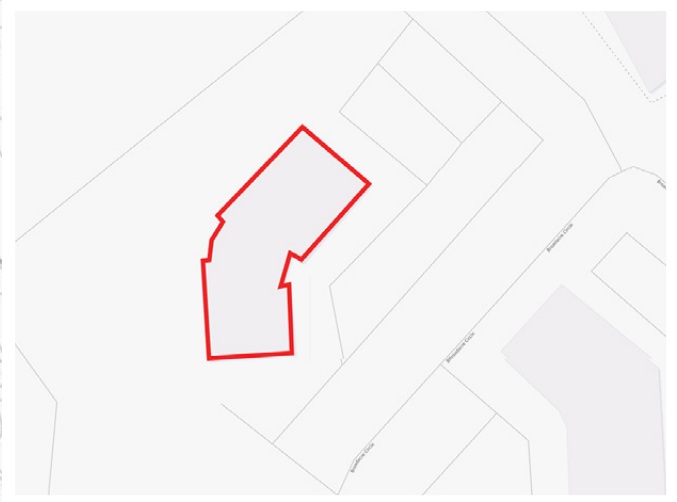
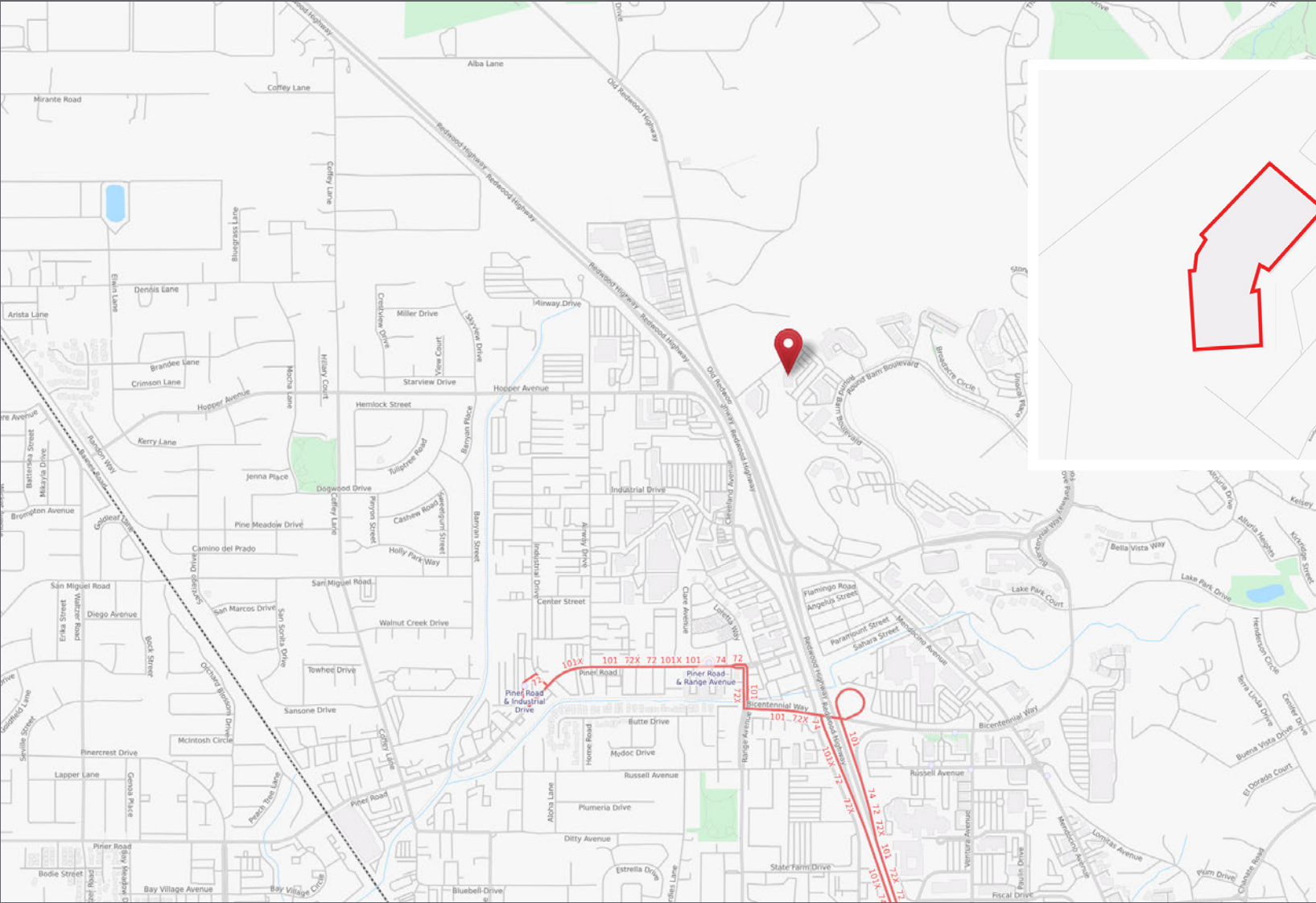

EXCLUSIVELY MARKETING BY:  
**Shawn Johnson**  
DRE#: 00835502

FOR LEASE **Santa Rosa**  
**Fountaingrove Executive Center**

**5,249 - 7,844 RSF** (Can be combined)

3562 Round Barn Circle  
Third Floor

Suite 330: 5,249 SF  
Suite 300: 7,844 SF  
Combined: 13,093 SF

